

Camp Road
St Albans



Strutt
& Parker

Land and property. Since 1885.

A bright and well-proportioned semi-detached home in a popular residential area of St Albans, benefiting from off-street parking and a generous private rear garden with excellent potential.

This semi-detached home offers approximately 838 sq ft of well-balanced accommodation arranged over two floors, with a neutral décor throughout providing an excellent opportunity for personalisation.

The ground floor comprises two distinct reception rooms, both finished with attractive wood-style flooring. To the front, the family room enjoys a large window allowing for an abundance of natural light. To the rear, a separate sitting room provides a more intimate living space, with glazed French doors opening directly onto the garden patio. The kitchen is fitted with a range of wooden wall and base units, generous worktop space and enjoys views across the rear garden. A convenient cloakroom completes the ground floor accommodation.

On the first floor, the landing leads to three bedrooms. The principal bedroom is notably well proportioned, with two further bedrooms offering flexibility for use as children's rooms, guest accommodation or a home office. The accommodation is served by a family bathroom fitted with a white suite and shower over bath, complemented by tiled surrounds.

Externally, the property benefits from a private brick-paved driveway providing off-street parking. Side access leads to a generous rear garden, featuring a paved patio area ideal for outdoor dining, which extends onto a long lawn bordered by fencing. The garden also includes a timber shed positioned to the rear, offering useful storage.



Location

The property is situated on Camp Road, a well-located residential area in the historic city of St Albans, offering convenient access to the city centre and nearby green spaces. St Albans provides a wide range of amenities including independent boutiques, restaurants, cafés, supermarkets and a vibrant weekly market, alongside leisure facilities and open spaces such as Verulamium Park and Heartwood Forest. The nearby towns of Harpenden and Hatfield offer further amenities, while central London is within easy reach. The area is well regarded for its schooling, with highly respected independent schools including St Albans School, St Albans High School for Girls and St Columba's College.

Communications are excellent, with St Albans City railway station providing fast and frequent Thameslink services to London St Pancras International in under 25 minutes, as well as connections north to Luton and Bedford. The M1, M25 and A1(M) are all within easy reach, offering convenient road links to London, the Home Counties and major airports including Heathrow, Luton and Gatwick.

Postcode region: AL1

General

Local Authority: St Albans City & District Council
Services: Mains electricity, gas, water & drainage
Council Tax: Band D
EPC Rating: D
Mobile and Broadband checker: Information can be found here
<https://checker.ofcom.org.uk/en-gb/>

838 sq ft (78 sq m)

2 reception rooms

3 bedrooms

1 bathroom

Garden

Driveway

Freehold | City

Guide price £750,000



Camp Road, St. Albans
Internal area 838 sq ft (78 sq m)

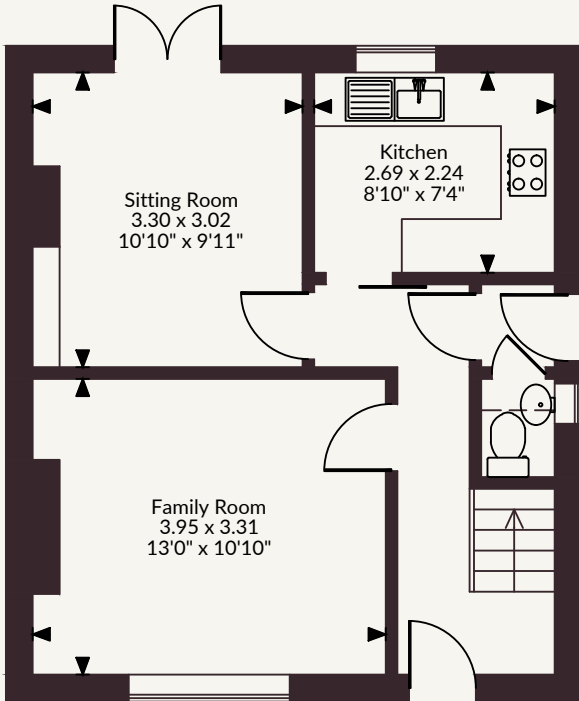
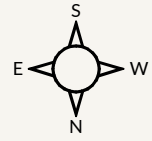

Ground Floor

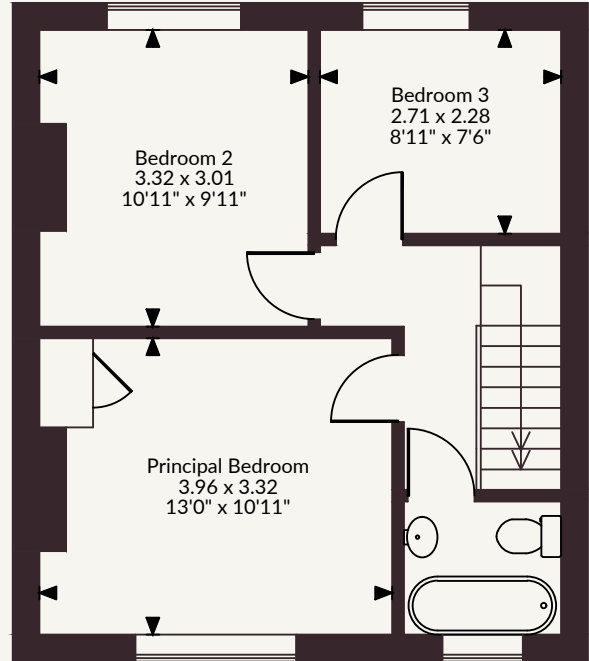

First Floor

FOR ILLUSTRATIVE PURPOSES ONLY - NOT TO SCALE

The position & size of doors, windows, appliances and other features are approximate only.

☐☐☐ Denotes restricted head height

© ehouse. Unauthorised reproduction prohibited. Drawing ref. dig/8693381/SS

St Albans

15 London Road, St Albans, AL1 1LA

01727 840285 | stalbans@struttandparker.com



@struttandparker struttandparker.com

**Strutt
& Parker**

Land and property. Since 1885.

IMPORTANT NOTICE: Strutt & Parker gives notice that: 1. These particulars do not constitute an offer or contract or part thereof. 2. All descriptions, photographs and plans are for guidance only and should not be relied upon as statements or representations of fact. All measurements are approximate and not necessarily to scale. Any prospective purchaser must satisfy themselves of the correctness of the information within the particulars by inspection or otherwise. 3. Strutt & Parker does not have any authority to give any representations or warranties whatsoever in relation to this property (including but not limited to planning/building regulations), nor can it enter into any contract on behalf of the Vendor. 4. Strutt & Parker does not accept responsibility for any expenses incurred by prospective purchasers in inspecting properties which have been sold, let or withdrawn. 5. We are able to refer you to SPF Private Clients Limited ("SPF") for mortgage broking services, and to Alexander James Interiors ("AJI"), an interior design service. Should you decide to use the services of SPF, we will receive a referral fee from them of 25% of the aggregate of the fee paid to them by you for the arrangement of a mortgage and any fee received by them from the product provider. Should you decide to use the services of AJI, we will receive a referral fee of 10% of the net income received by AJI for the services they provide to you. 6. If there is anything of particular importance to you, please contact this office and Strutt & Parker will try to have the information checked for you. Strutt & Parker is a trading style of BNP Paribas Real Estate Advisory & Property Management UK Limited. Photographs taken May 2026. Particulars prepared May 2026.