

Donovan Court

Drayton Gardens, SW10

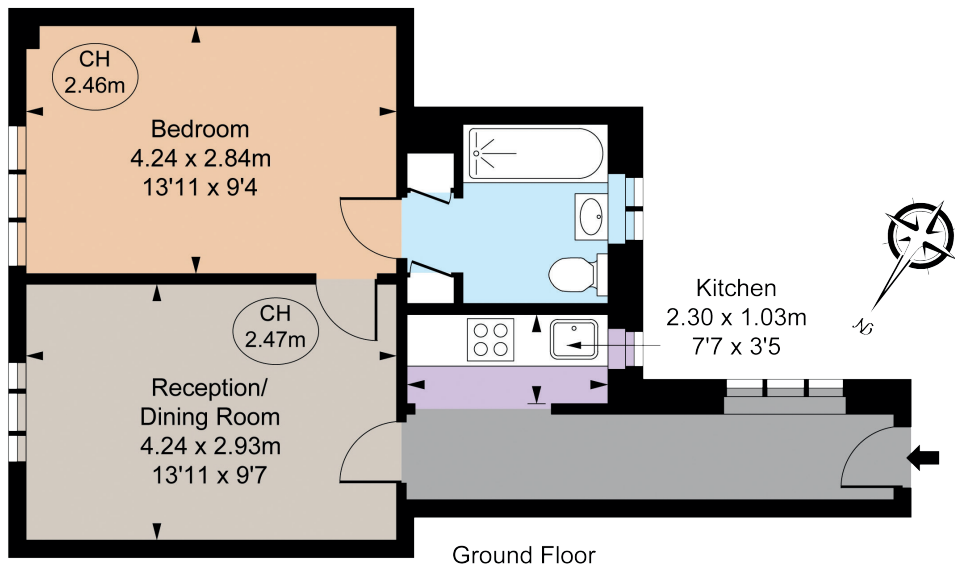



A well-positioned one-bedroom flat, situated on the ground floor, set within a secure development.

Set within the popular art-deco mansion block Donovan Court, located in the heart of Chelsea.

Given its convenient location, this property is perfect for a first-time buyer, rental investment or for use as a Pied a Terre. Situated directly opposite Chelsea's 'Picture House' cinema and right on 'The Beach' part of Fulham Road, a highly sought-after stretch, conveniently positioned for the many boutique shops, bars and restaurants found in this location. Furthermore, Donovan Court is within close proximity to Gloucester Road (District & Piccadilly Lines) and South Kensington (District, Piccadilly & Circle Lines) tube stations. The property is offered to the market with no chain and with 105 years remaining on the lease.

Floorplans

Gross internal area 415 sq ft (38.58 sq m)
For identification purposes only.

General

Tenure: Leasehold 104yrs 1 month
Local Authority: The Royal Borough of Kensington and Chelsea
Service Charge: £2,500 per annum
Ground Rent: Peppercorn
Council Tax: Band E
EPC Rating: C
Parking: Available
Broadband: Available
Asking Price: £500,000

Chelsea SW10

140 Fulham Road, London, SW10 9PY

020 7373 1010

chelseaSW10@struttandparker.com
struttandparker.com

IMPORTANT NOTICE: Strutt & Parker gives notice that: 1. These particulars do not constitute an offer or contract or part thereof. 2. All descriptions, photographs and plans are for guidance only and should not be relied upon as statements or representations of fact. All measurements are approximate and not necessarily to scale. Any prospective purchaser must satisfy themselves of the correctness of the information within the particulars by inspection or otherwise. 3. Strutt & Parker does not have any authority to give any representations or warranties whatsoever in relation to this property (including but not limited to planning/building regulations), nor can it enter into any contract on behalf of the Vendor. 4. Strutt & Parker does not accept responsibility for any expenses incurred by prospective purchasers in inspecting properties which have been sold, let or withdrawn. 5. We are able to refer you to SPF Private Clients Limited ("SPF") for mortgage broking services, and to Alexander James Interiors ("AJI"), an interior design service. Should you decide to use the services of SPF, we will receive a referral fee from them of 25% of the aggregate of the fee paid to them by you for the arrangement of a mortgage and any fee received by them from the product provider. Should you decide to use the services of AJI, we will receive a referral fee of 10% of the net income received by AJI for the services they provide to you. 6. If there is anything of particular importance to you, please contact this office and Strutt & Parker will try to have the information checked for you. Photographs taken June 2024. Particulars prepared May 2025. Strutt & Parker is a trading style of BNP Paribas Real Estate Advisory & Property Management UK Limited



@struttandparker

Over 50 offices across England and Scotland,
including Prime Central London

For the finer things in property.

**STRUTT
& PARKER**

BNP PARIBAS GROUP