



Drayton Gardens, SW10

Drayton Gardens, SW10

A fantastic two bedroom apartment located on the first floor of this attractive and well maintained red brick Victorian building in a prime Chelsea location, SW10. The property boasts a wealth of natural light and generous ceiling height.

The flat is offered in excellent condition throughout and benefits from two double bedrooms.

Additional benefits include a lift, caretaker and communal garden accessed within the building.

Two bedrooms | Once reception room | One bathroom | Lift | Communal gardens | EPC C Council tax F

Terms

Local Authority: The Royal Borough of Kensington and Chelsea

Price: £1153.85 per week *plus charges

*The charges clause needs to be added:
Charges: The following charges may apply
– Preparation of a Non Housing Act Tenancy Agreement £354 (Inc VAT) and Credit Reference per applicant £70 (Inc VAT)

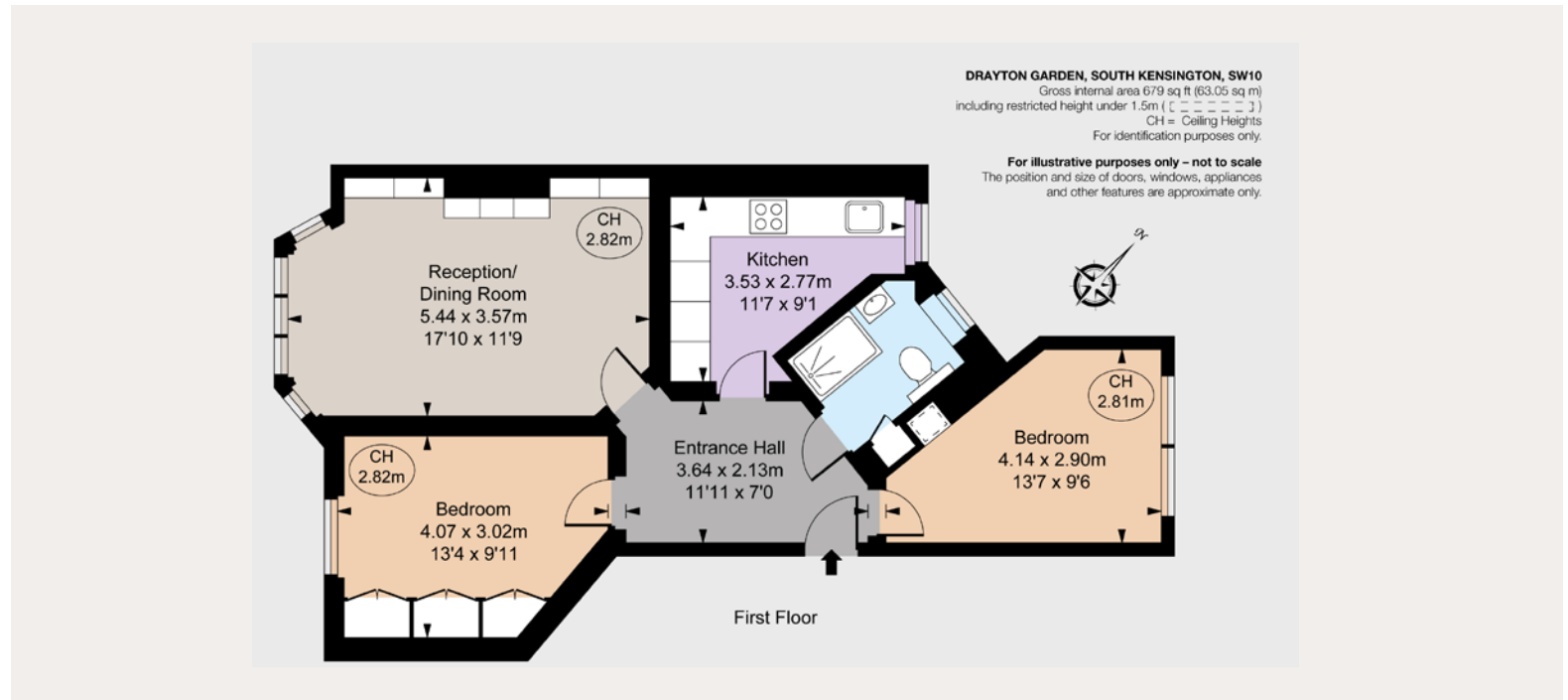

South Kensington

90 Old Brompton Road, London, SW7 3LQ

020 7581 7000

southken@struttandparker.com

IMPORTANT NOTICE: Strutt & Parker gives notice that: 1. These particulars do not constitute an offer or contract or part thereof. 2. All descriptions, photographs and plans are for guidance only and should not be relied upon as statements or representations of fact. All measurements are approximate and not necessarily to scale. Any prospective purchaser must satisfy themselves of the correctness of the information within the particulars by inspection or otherwise. 3. Strutt & Parker does not have any authority to give any representations or warranties whatsoever in relation to this property (including but not limited to planning/building regulations), nor can it enter into any contract on behalf of the Vendor. 4. Strutt & Parker does not accept responsibility for any expenses incurred by prospective purchasers in inspecting properties which have been sold, let or withdrawn. 5. We are able to refer you to SPF Private Clients Limited ("SPF") for mortgage broking services, and to Alexander James Interiors ("AJI"), an interior design service. Should you decide to use the services of SPF, we will receive a referral fee from them of 25% of the aggregate of the fee paid to them by you for the arrangement of a mortgage and any fee received by them from the product provider. Should you decide to use the services of AJI, we will receive a referral fee of 10% of the net income received by AJI for the services they provide to you. 6. If there is anything of particular importance to you, please contact this office and Strutt & Parker will try to have the information checked for you. Photographs taken September 2023. Particulars prepared September 2023 Strutt & Parker is a trading style of BNP Paribas Real Estate Advisory & Property Management UK Limited.