

Lancaster Court

London, SW6

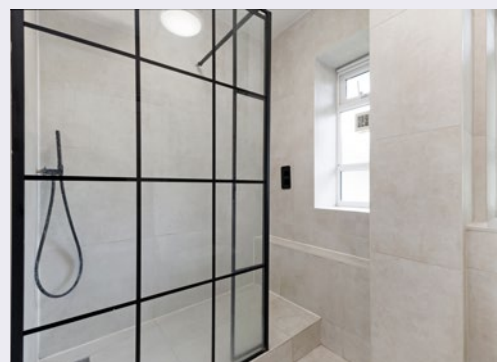

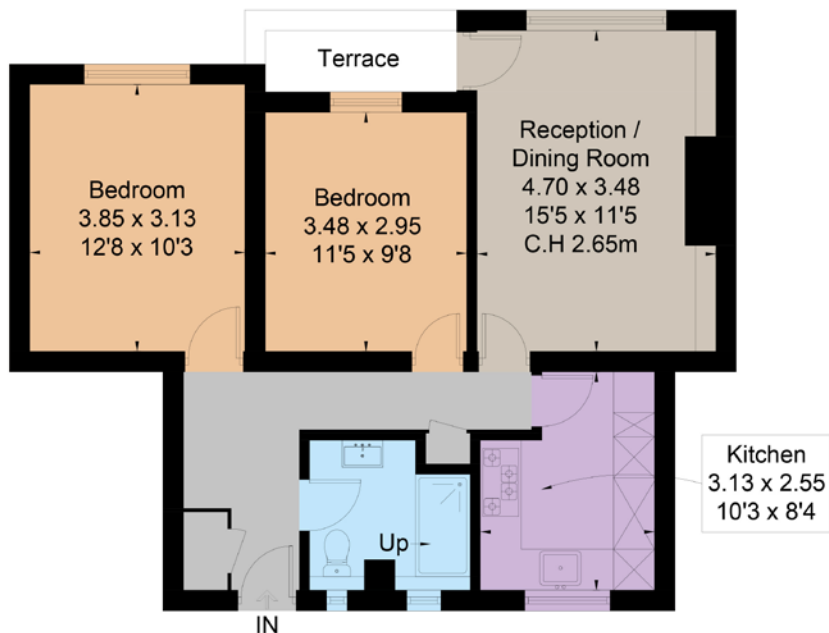

A spacious 700ft property, perfectly located in prime Parsons Green.

A modern, well-presented 2 bedroom, ground floor flat in the heart of SW6.

With wood effect flooring throughout, this spacious property also includes a balcony and communal garden. There is also ample built in storage throughout, a well-equipped kitchen with integrated appliances and newly renovated bathroom. The flat is in turnkey condition, a perfect first home to get a foot on the property ladder or very readily lettable.

Lancaster Court is extremely well located, just moments away from both Parsons Green and Fulham Broadway Underground stations (District Line) for easy access into the city. It is also minutes away from the beautiful green spaces of Parsons Green / Eel Brook Common and the plethora of local amenities.

Floorplans

Gross internal area 698 sq ft (64.9 sq m)
For identification purposes only.

General

Tenure: Leasehold 108 years remaining

Local Authority: The London Borough of Hammersmith and Fulham

Service Charge: £1,440pa

Ground Rent: £50pa

Council Tax: Band C

EPC Rating: C

Parking: Residents parking permit available

Broadband: Installed

Asking Price: £550,000

Chelsea SW10

140 Fulham Road, London, SW10 9PY

020 7373 1010

chelseaSW10@struttandparker.com
struttandparker.com

IMPORTANT NOTICE: Strutt & Parker gives notice that: 1. These particulars do not constitute an offer or contract or part thereof. 2. All descriptions, photographs and plans are for guidance only and should not be relied upon as statements or representations of fact. All measurements are approximate and not necessarily to scale. Any prospective purchaser must satisfy themselves of the correctness of the information within the particulars by inspection or otherwise. 3. Strutt & Parker does not have any authority to give any representations or warranties whatsoever in relation to this property (including but not limited to planning/building regulations), nor can it enter into any contract on behalf of the Vendor. 4. Strutt & Parker does not accept responsibility for any expenses incurred by prospective purchasers in inspecting properties which have been sold, let or withdrawn. 5. We are able to refer you to SPF Private Clients Limited ("SPF") for mortgage broking services, and to Alexander James Interiors ("AJI"), an interior design service. Should you decide to use the services of SPF, we will receive a referral fee from them of 25% of the aggregate of the fee paid to them by you for the arrangement of a mortgage and any fee received by them from the product provider. Should you decide to use the services of AJI, we will receive a referral fee of 10% of the net income received by AJI for the services they provide to you. 6. If there is anything of particular importance to you, please contact this office and Strutt & Parker will try to have the information checked for you. Photographs taken August 2025. Particulars prepared August 2025. Strutt & Parker is a trading style of BNP Paribas Real Estate Advisory & Property Management UK Limited



@struttandparker

Over 50 offices across England and Scotland,
including Prime Central London

For the finer things in property.

**STRUTT
& PARKER**

BNP PARIBAS GROUP