



The image shows a bright, modern interior space, likely a living and dining area. On the left, there is a kitchen island with a black countertop and white cabinetry. A sink and a window with a light-colored blind are visible above the counter. To the right of the island is a dining area with a dark wooden table and white chairs. Further right is a living area with a light-colored sofa, a round coffee table, and a glass-topped side table. Large windows with grey curtains are on the right wall, providing natural light. The ceiling has recessed lighting and a modern pendant light fixture hangs over the dining area. The floor is covered in light-colored wood or laminate.

Gledhow Gardens

SOUTH KENSINGTON SW5

Located on the prestigious Gledhow Gardens in South Kensington, this impressive first-floor apartment exudes elegance and sophistication, having been meticulously interior-designed to the highest standard

The property boasts high ceilings and grand windows, flooding each room with natural light and enhancing the feeling of spaciousness. The generous open-plan reception room is adorned with exquisite detailing and custom finishes, providing a beautiful setting for both entertaining and relaxation. The apartment further extends to a luxurious bedroom, which offers a tranquil atmosphere with bespoke wardrobes and opulent touches, while the designer bathroom features high-end fixtures and refined finishes.

The property also grants residents access to stunning private communal gardens, adding an oasis of greenery in one of the most sought-after neighbourhoods.





Accommodation

- Reception room
- Bedroom
- Bathroom
- Residents' parking

Situation

Gledhow Gardens is a quiet tree-lined street located in the heart of South Kensington, close to the local amenities and transport links of South Kensington and Gloucester Road.

Terms

Tenure

Leasehold with 963 years left

Ground Rent

Peppercorn

Service Charge

£7,200 per annum

EPC

Rating D

Local Authority

The Royal Borough of Kensington & Chelsea

Council Tax

Band D

Guide Price

£1,350,000



Approximate Internal Floor Area

611 sq ft / 56.7 sq m

CH: Ceiling height

This plan is not to scale (unless specified), and is for guidance only, and must not be relied upon as a statement of fact. All measurements and areas are approximate only, and have been prepared in accordance with the current edition of the RICS Code of Measuring Practice. Please read the Important Notice on the last page of the text of the particulars.

This floorplan has been supplied to The Brochure by Strutt & Parker

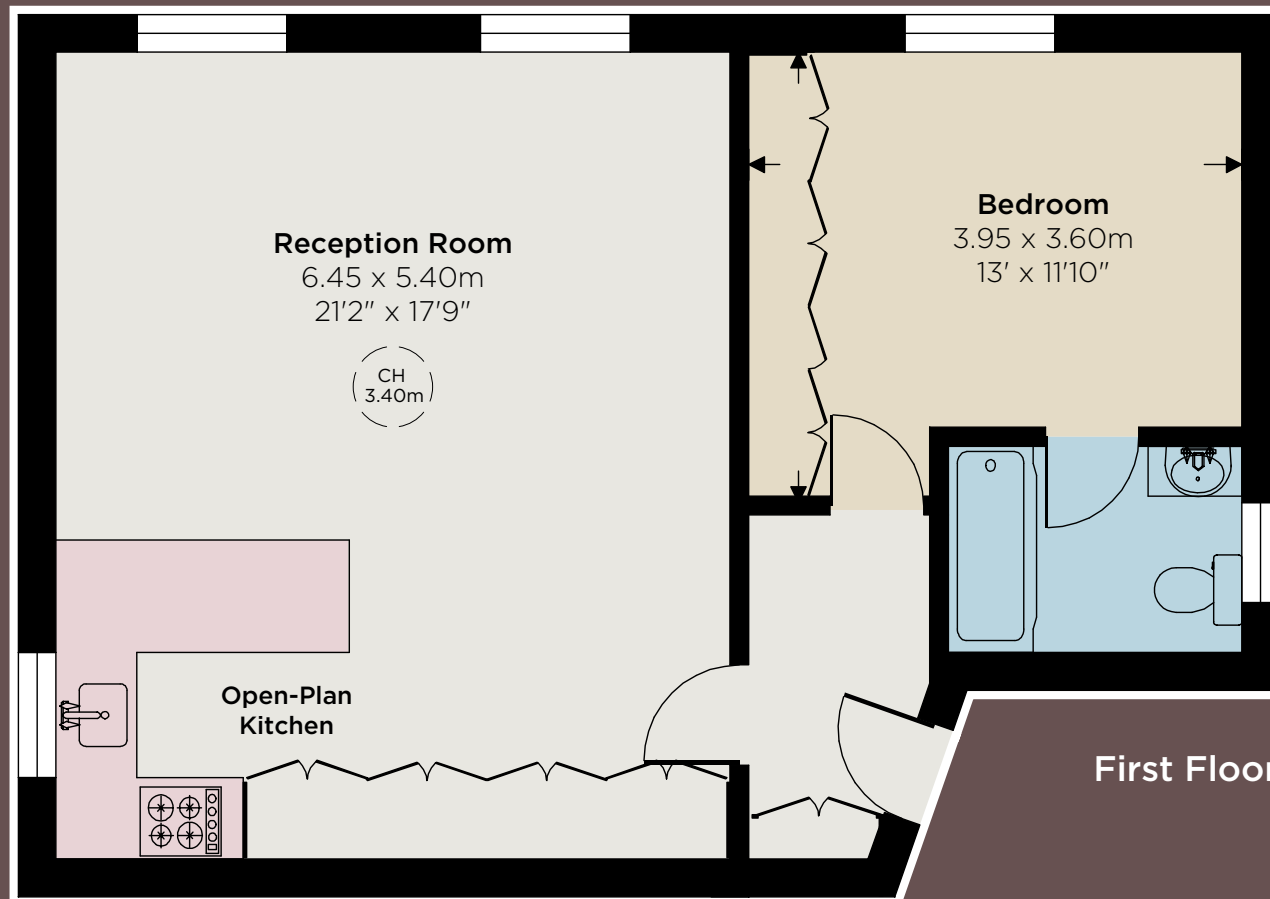

IMPORTANT NOTICE: Strutt & Parker gives notice that: 1. These particulars do not constitute an offer or contract or part thereof. 2. All descriptions, photographs and plans are for guidance only and should not be relied upon as statements or representations of fact. All measurements are approximate and not necessarily to scale. Any prospective purchaser must satisfy themselves of the correctness of the information within the particulars by inspection or otherwise. 3. Strutt & Parker does not have any authority to give any representations or warranties whatsoever in relation to this property (including but not limited to planning/building regulations), nor can it enter into any contract on behalf of the Vendor. 4. Strutt & Parker does not accept responsibility for any expenses incurred by prospective purchasers in inspecting properties which have been sold, let or withdrawn. 5. We are able to refer you to SPF Private Clients Limited ("SPF") for mortgage broking services, and to Alexander James Interiors ("AJI"), an interior design service. Should you decide to use the services of SPF, we will receive a referral fee from them of 25% of the aggregate of the fee paid to them by you for the arrangement of a mortgage and any fee received by them from the product provider. Should you decide to use the services of AJI, we will receive a referral fee of 10% of the net income received by AJI for the services they provide to you. 6. If there is anything of particular importance to you, please contact this office and Strutt & Parker will try to have the information checked for you. Photographs taken September 2024. Particulars prepared October 2024. Strutt & Parker is a trading style of BNP Paribas Real Estate Advisory & Property Management UK Limited. 09/07/25S&P-241030C-08-JF

South Kensington

90 Old Brompton Road, London SW7 3LQ

+44 (0)20 7581 7000

southken@struttandparker.com

struttandparker.com

THE BROCHURE



@struttandparker

Over 50 offices across England and Scotland, including Prime Central London

For the finer things in property.

