

Gunter Grove

London, SW10



A well-presented one-bedroom flat positioned on the second floor.

A well-appointed one-bedroom flat, set within an attractive period conversion. The flat features a contemporary finish and benefits from wonderful natural light throughout.



1 RECEPTION ROOM



1 BEDROOM



1 BATHROOM



SHARE OF FREEHOLD



467 SQ FT



**ASKING PRICE
£550,000**



The property

This flat is perfect for first-time buyers, investors or for use as a pied-à-terre.

Offered to the market chain-free and with a Share of Freehold.

Location

Gunter Grove is positioned between the King's Road and the Fulham Road, conveniently located for the many local shops, cafes and restaurants. This flat is perfect for first-time buyers, investors or for use as a Pied a Terre. Offered to the market chain-free and with a Share of Freehold.





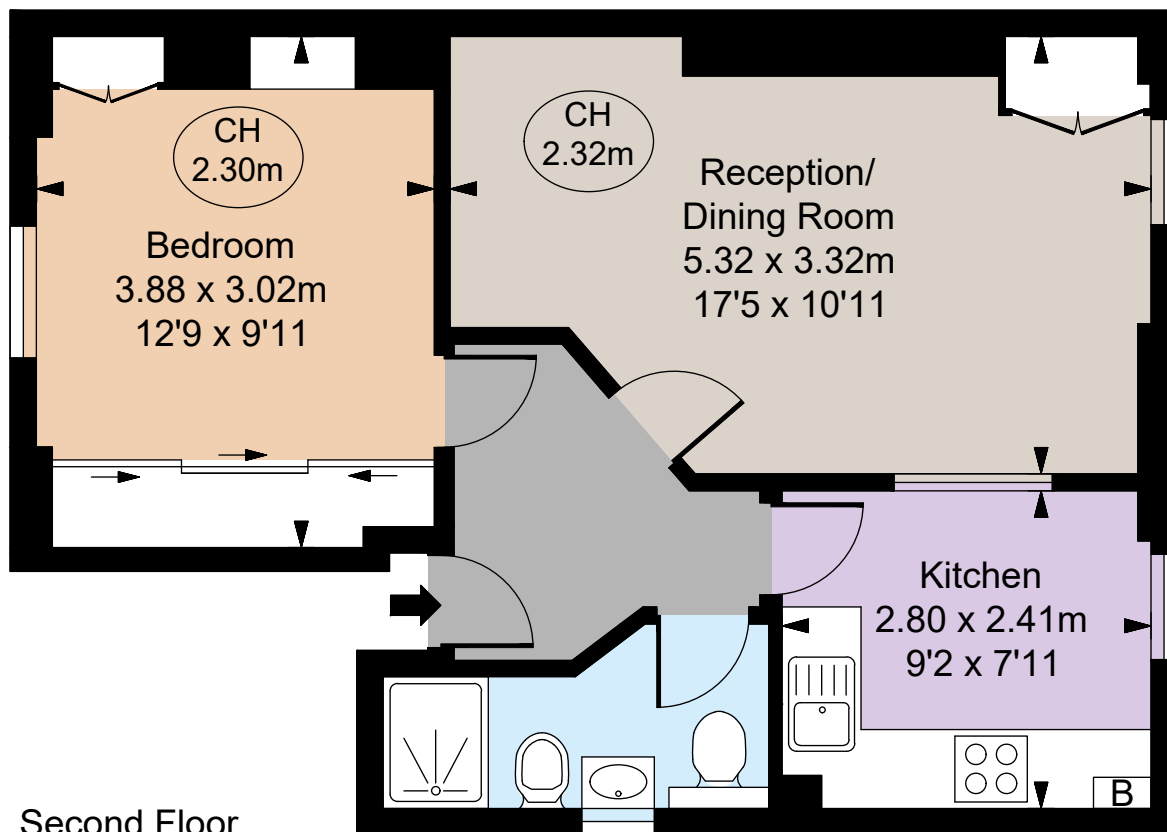

Second Floor

Floorplans

Gross internal area 467 sq ft (43.34 sq m)
For identification purposes only.

General

Tenure: Share of freehold 986 years

Local Authority: Hammersmith and Fulham

Service Charge: £3,300 pa

Ground Rent: N/A

Council Tax: Band D

EPC Rating: C

Parking: Residents' parking

Broadband: Installed

IMPORTANT NOTICE: Strutt & Parker gives notice that: 1. These particulars do not constitute an offer or contract or part thereof. 2. All descriptions, photographs and plans are for guidance only and should not be relied upon as statements or representations of fact. All measurements are approximate and not necessarily to scale. Any prospective purchaser must satisfy themselves of the correctness of the information within the particulars by inspection or otherwise. 3. Strutt & Parker does not have any authority to give any representations or warranties whatsoever in relation to this property (including but not limited to planning/building regulations), nor can it enter into any contract on behalf of the Vendor. 4. Strutt & Parker does not accept responsibility for any expenses incurred by prospective purchasers in inspecting properties which have been sold, let or withdrawn. 5. We are able to refer you to SPF Private Clients Limited ("SPF") for mortgage broking services, and to Alexander James Interiors ("AJI"), an interior design service. Should you decide to use the services of SPF, we will receive a referral fee from them of 25% of the aggregate of the fee paid to them by you for the arrangement of a mortgage and any fee received by them from the product provider. Should you decide to use the services of AJI, we will receive a referral fee of 10% of the net income received by AJI for the services they provide to you. 6. If there is anything of particular importance to you, please contact this office and Strutt & Parker will try to have the information checked for you. Photographs taken xxxxxxxx 2025. Particulars prepared March 2025. Strutt & Parker is a trading style of BNP Paribas Real Estate Advisory & Property Management UK Limited

Chelsea SW10

140 Fulham Road, London, SW10 9PY

020 7373 1010

chelseaSW10@struttandparker.com
struttandparker.com



@struttandparker

Over 50 offices across England and Scotland,
including Prime Central London

For the finer things in property.

**STRUTT
& PARKER**

BNP PARIBAS GROUP