

Hollycroft Avenue,
Hampstead



Strutt
& Parker

Land and property. Since 1885.

Edwardian home extending to approximately 4,244 sq ft.

Built in 1912, a stunning family home located on a sought-after position within the Crofts. Further benefiting from off street parking and south west facing gardens.

An outstanding 6-bedroom Edwardian home, built circa 1912, and located on a tree lined avenue within the 'Crofts' Hampstead, further benefitting from a south west facing garden and driveway for two cars.

Extending to approx. 4,244 sq ft / 394.3 sq m this beautiful home retails a wealth of period features, and the bright, and spacious accommodation is positioned over only three floors. The elevated ground floor entrance leads to an impressive entrance hall that gives access to three intercommunicating reception rooms, a separate WC, and a large a kitchen/breakfast room that opens on to the private, mature south west facing rear garden.

In addition, there is an excellent studio room with kitchenette that is adaptable dependent on requirements. Across the two top floors are six bedrooms including an expansive principal suite with two dressing rooms and a large en-suite bathroom. There are two additional bathrooms and access to a south west facing roof terrace and eaves storage.



Location

Hollycroft Avenue is a 0.7 mile walk from the numerous amenities of Hampstead Village, including many boutiques, restaurants and cafes. Transport links include Hampstead Underground Station (Northern Line) and numerous bus routes on Finchley Road. The 800 acre expanse of Hampstead Heath is located just 0.3 miles away.

Postcode region: NW3

General

Local Authority: London Borough of Camden
Council Tax: Band H
EPC Rating: D
Parking: Off street parking
Mobile coverage and broadband: Information can be found here: <https://checker.ofcom.org.uk/en-gb/mobile-coverage>

4,244 sq ft (394.3 sq m)
6 bedrooms
3 reception rooms
South west facing garden
Roof terrace
Freehold

Guide price £5,750,000





HOLLYCROFT AVENUE
LONDON NW3
Gross Internal Area = 391.3 sq metres
(Excluding Low Heights) 4212 sq feet

SITE = 0.12 ACRES

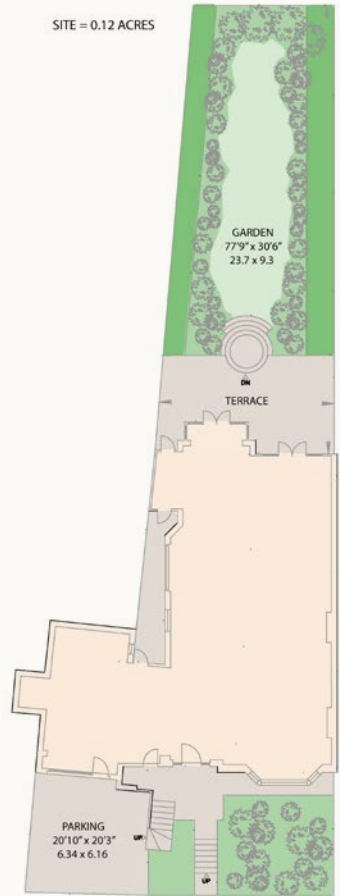

Strutt & Parker Hampstead

020 7591 2225 | hampstead@struttandparker.com



@struttandparker

struttandparker.com

**Strutt
& Parker**

Land and property. Since 1885.

IMPORTANT NOTICE: Strutt & Parker gives notice that: 1. These particulars do not constitute an offer or contract or part thereof. 2. All descriptions, photographs and plans are for guidance only and should not be relied upon as statements or representations of fact. All measurements are approximate and not necessarily to scale. Any prospective purchaser must satisfy themselves of the correctness of the information within the particulars by inspection or otherwise. 3. Strutt & Parker does not have any authority to give any representations or warranties whatsoever in relation to this property (including but not limited to planning/building regulations), nor can it enter into any contract on behalf of the Vendor. 4. Strutt & Parker does not accept responsibility for any expenses incurred by prospective purchasers in inspecting properties which have been sold, let or withdrawn. 5. We are able to refer you to SPF Private Clients Limited ("SPF") for mortgage broking services, and to Alexander James Interiors ("AJI"), an interior design service. Should you decide to use the services of SPF, we will receive a referral fee from them of 25% of the aggregate of the fee paid to them by you for the arrangement of a mortgage and any fee received by them from the product provider. Should you decide to use the services of AJI, we will receive a referral fee of 10% of the net income received by AJI for the services they provide to you. 6. If there is anything of particular importance to you, please contact this office and Strutt & Parker will try to have the information checked for you. Strutt & Parker is a trading style of BNP Paribas Real Estate Advisory & Property Management UK Limited. Photographs taken May 2026. Particulars prepared May 2026.