



Ladbroke Grove, Notting Hill, W11

For the finer things in property.

**STRUTT  
& PARKER**

BNP PARIBAS GROUP 

# Ladbroke Grove, Notting Hill, W11

Discover this delightful, raised ground floor flat in a grand period conversion, nestled in the heart of Notting Hill.

Featuring high ceilings and a stunning large bay window, which fill the space with natural light. Open plan kitchen/reception offers the perfect space for entertaining and relaxing. Enjoy the benefits of a highly regarded location with easy access to the exclusive Blenheim-Elgin private gardens. This flat also boasts a generous storage room, providing ample space for all your belongings, and an internal laundry for added convenience.

Situated within close proximity to the excellent shopping and restaurants of Westbourne Grove and Portobello Road/Market, the flat is also a short distance from Ladbroke Grove, and Holland Park underground stations.

1 Bedroom | 1 Reception room | 1 Bathroom  
Large additional storage cupboard allocated to the flat | 1 Kitchen | Access to communal gardens | EPC Rating C

## Terms

**Tenure:** Share of freehold, 999 years from 2009

**Service Charge:** £2,760

**Reserve Contribution:** £624

**Council Tax:** Band C

**Local Authority:** The Royal Borough of Kensington and Chelsea

**Asking Price:** £545,000

## Notting Hill

303 Westbourne Grove, London, W11 2QA

**020 7221 1111**

nottinghill@struttandparker.com

struttandparker.com

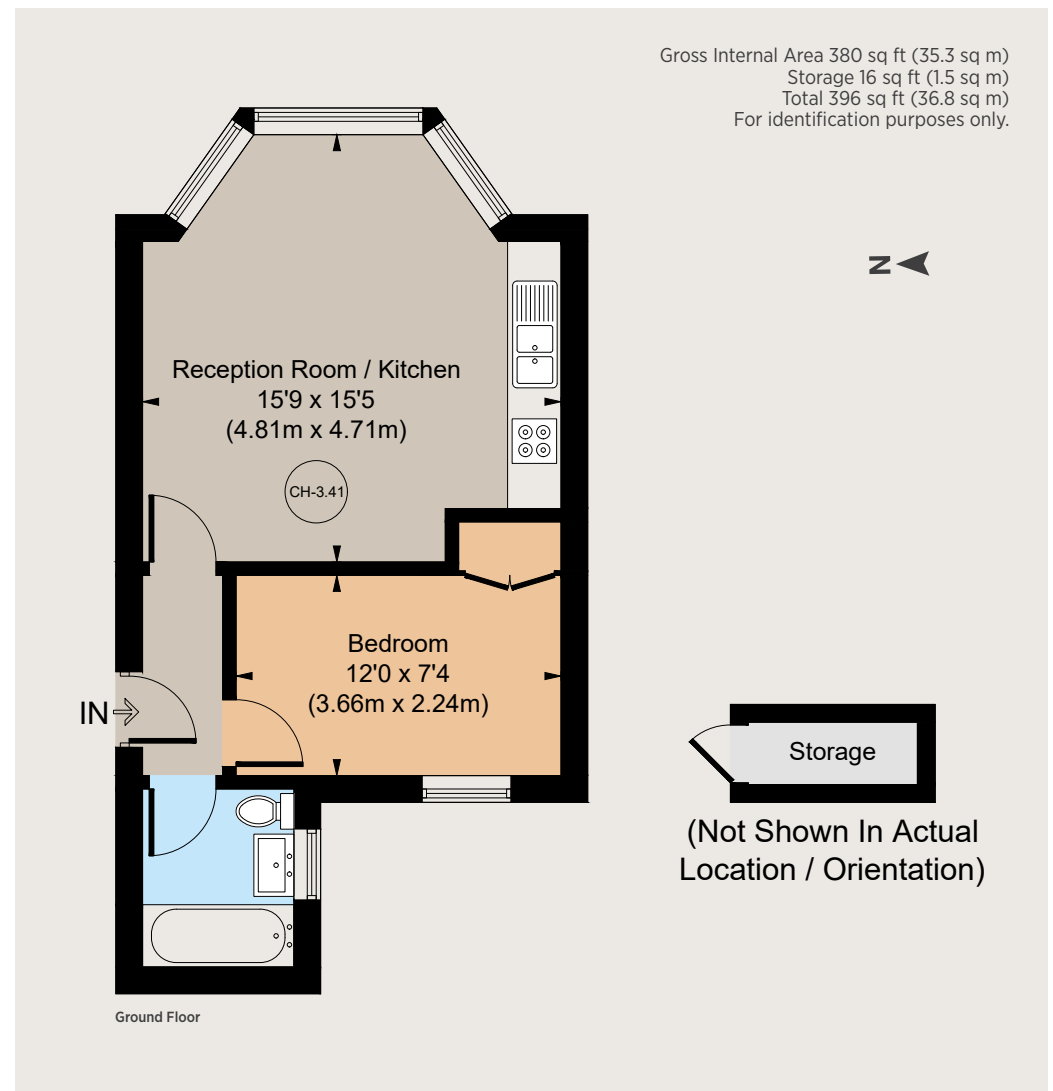

### IMPORTANT NOTICE

Strutt & Parker gives notice that: 1. These particulars do not constitute an offer or contract or part thereof. 2. All descriptions, photographs and plans are for guidance only and should not be relied upon as statements or representations of fact. All measurements are approximate and not necessarily to scale. Any prospective purchaser must satisfy themselves of the correctness of the information within the particulars by inspection or otherwise. 3. Strutt & Parker does not have any authority to give any representations or warranties whatsoever in relation to this property (including but not limited to planning/building regulations), nor can it enter into any contract on behalf of the Vendor. 4. Strutt & Parker does not accept responsibility for any expenses incurred by prospective purchasers in inspecting properties which have been sold, let or withdrawn. 5. We are able to refer you to SPF Private Clients Limited ("SPF") for mortgage broking services, and to Alexander James Interiors ("AJI"), an interior design service. Should you decide to use the services of SPF, we will receive a referral fee from them of 25% of the aggregate of the fee paid to them by you for the arrangement of a mortgage and any fee received by them from the product provider. Should you decide to use the services of AJI, we will receive a referral fee of 10% of the net income received by AJI for the services they provide to you. 6. If there is anything of particular importance to you, please contact this office and Strutt & Parker will try to have the information checked for you. Photographs taken October 2024. Particulars prepared October 2024. Strutt & Parker is a trading style of BNP Paribas Real Estate Advisory & Property Management UK Limited.



Over 50 offices across England and Scotland,  
including Prime Central London

For the finer things in property.

**STRUTT  
& PARKER**

BNP PARIBAS GROUP