



Birdsong House, Manor Road, Twyford, Winchester,  
Hampshire

For the finer things in property.

**STRUTT  
& PARKER**

BNP PARIBAS GROUP



# Birdsong House, Manor Road, Twyford, Winchester, Hampshire, SO21 1RJ

A superb, detached family home with versatile accommodation in the heart of the pretty village of Twyford.

Shawford (main line railway to London Waterloo) 0.8 miles , Winchester 3.8 miles, Southampton 11.2 miles

Hall | Sitting room | Snug | Study | Conservatory  
Kitchen/dining room | Utility | Cloakroom  
Principal bedroom with en-suite bathroom  
4 Further bedrooms | Family bathroom  
Annexe with sitting room, kitchen/dining room,  
2 bedrooms, bathroom and cloakroom | Double  
garage | Established garden | EPC Rating D

## The property

Positioned in the heart of the pretty village of Twyford, Birdsong House has been a comfortable and spacious family home to the current proprietors for many years. Built in 1998 the house offers the opportunity for multi-generational living and the versatile accommodation can be used to suit various situations.

The ground floor of the home offers excellent family living, with a larger entrance hall, WC and a perfect family space comprising the Kitchen, Dining area and a cosy snug with a beautiful log burning stove at its heart. From the dining room is a delightful garden room which offers a comfortable spot to enjoy the garden on cooler days and watch the seasons pass. Further accommodation comprises a study, which is the link between the main house and the annexe, a utility room and a large formal sitting room with french doors leading onto the garden also with

a feature inglenook fireplace.

To the first floor is an impressive principle bedroom with an en-suite bathroom and built in storage. There are four further bedrooms with a useful 'Jack and Jill' style bathroom making this an adaptable space for family life.

## Mallard Cottage

The annexe adjoining Birdsong House is a perfect place for visitors to stay, completely self-contained with its own front door, the kitchen is complete with everything you would need for visitors or long term guests. There is a cosy sitting room with space for a dining table, as well as a downstairs WC. To the first floor are two double bedrooms and a bathroom. A great opportunity for multi-generational living or just somewhere for friends and family to stay.

## Outside

Birdsong House is approached via gravel driveway with impressive double gates which in turn leads to ample parking for a number of cars. There is a useful double garage as well as a further garden shed for storage. The garden is predominantly laid to lawn with plant and shrub borders wrapping around the house and creating a real feeling of space and privacy. The current owners have apportioned part of the garden to the annexe which makes a perfect spot to grow vegetables and herbs if you so wish.

## Location

Nestled within the heart of Twyford Village, the home is positioned away from the main roads and offers a quiet haven. Twyford includes a popular primary school, Twyford Preparatory School, a village shop and two pubs to choose from. Not to mention Shawford Station which is on the main line to London Waterloo just down the road. There is also a doctors surgery and chemist meaning most needs are catered for. Brilliant dog walks and Hunters Park are nearby. The historic City of Winchester is approximately 8 miles away and offers a wider range of shops, restaurants and facilities.









# Birdsong House

Approximate Gross Internal Area  
Main House = 3106 Sq Ft / 288.58 Sq M  
Garage = 291 Sq Ft / 27.04 Sq M  
Total = 3397 Sq Ft / 315.62 Sq M

Outbuildings are not shown in correct orientation or location.  
Includes areas with restricted height less than 1.5m.

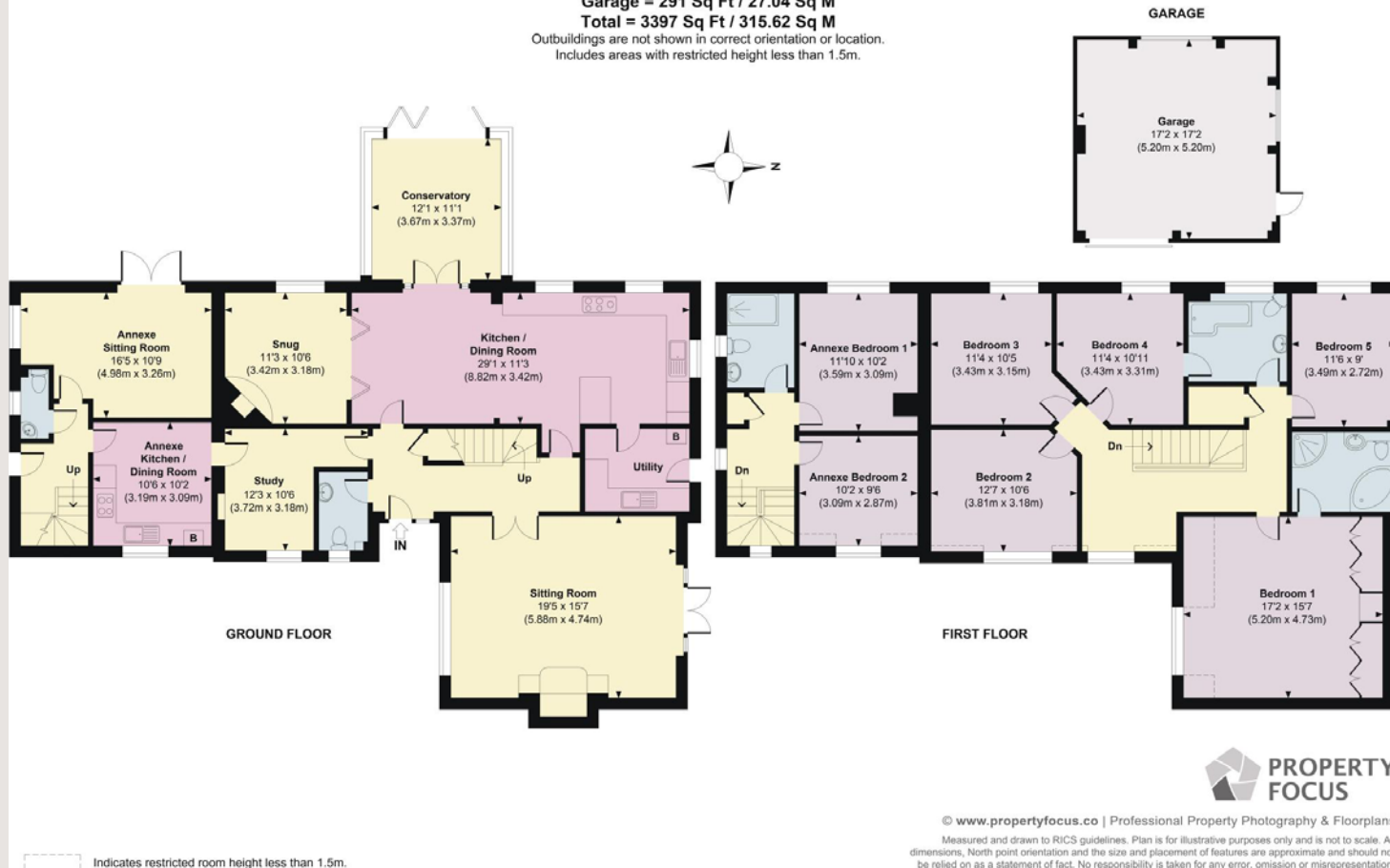

## Directions

What3Words:///manual.bucked.ground

## General

**Local Authority:** Winchester City Council

**Services:** Main House - mains electricity, gas, water and drainage. Annexe - mains electricity, water, drainage and LPG heating

**Council Tax:** Band G

**Agents note:** Birdsong House has a right of access over the drive of Tonawanda

**Tenure:** Freehold

**Guide Price:** £1,500,000

## Winchester

6 Jewry Street, Winchester SO23 8RZ

**01962 869999**

winchester@struttandparker.com  
struttandparker.com

@struttandparker

/struttandparker

Over 45 offices across England and Scotland,  
including Prime Central London

**IMPORTANT NOTICE:** Strutt & Parker gives notice that: 1. These particulars do not constitute an offer or contract or part thereof. 2. All descriptions, photographs and plans are for guidance only and should not be relied upon as statements or representations of fact. All measurements are approximate and not necessarily to scale. Any prospective purchaser must satisfy themselves of the correctness of the information within the particulars by inspection or otherwise. 3. Strutt & Parker does not have any authority to give any representations or warranties whatsoever in relation to this property (including but not limited to planning/building regulations), nor can it enter into any contract on behalf of the Vendor. 4. Strutt & Parker does not accept responsibility for any expenses incurred by prospective purchasers in inspecting properties which have been sold, let or withdrawn. 5. We are able to refer you to SPF Private Clients Limited ("SPF") for mortgage broking services, and to Alexander James Interiors ("AJI"), an interior design service. Should you decide to use the services of SPF, we will receive a referral fee from them of 25% of the aggregate of the fee paid to them by you for the arrangement of a mortgage and any fee received by them from the product provider. Should you decide to use the services of AJI, we will receive a referral fee of 10% of the net income received by AJI for the services they provide to you. 6. If there is anything of particular importance to you, please contact this office and Strutt & Parker will try to have the information checked for you. Photographs taken Summer 2023. Particulars prepared March 2024. Strutt & Parker is a trading style of BNP Paribas Real Estate Advisory & Property Management UK Limited

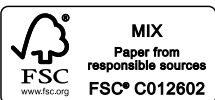

For the finer things in property.

