



3 Red Houses, Rhyd Y Goleu, Rhosesmor

3 Red Houses Rhyd Y Goleu, Rhosesmor, Mold, CH7 6LZ

A Grade II listed 3 bedroom property in a sought-after location close to town centre amenities.

Mold 1.1 miles, Flint and station 5.7 miles (London Euston 2 hours 20 minutes), Holywell 8.3 miles, Wrexham 12.6 miles, Chester 13.0 miles, Buckley station 4.9 miles (London Euston 2 hours 43 minutes)

Entrance hall | Sitting room | Kitchen/breakfast room | 3 Bedrooms | Family bathroom | Garden Outbuilding | EPC Rating F

The property

Built in 1911 for Philip Tatton Davies-Cooke of the historic Gwysaney estate, 3 Red Houses is a red brick family home offering attractive accommodation arranged in an L-shaped configuration over two floors. The property has been sensitively modernised yet retains character features throughout.

The ground floor accommodation comprises an entrance hallway, generous sitting room with a tiled open fireplace and a large rear aspect kitchen/breakfast room with a tiled open fireplace, a range of wall and base units with complementary work surfaces over, space for modern integrated appliances and a good-sized table. A modern fully-tiled family bathroom and rear hallway completes the ground floor facilities.

On the first floor the property offers a generous front aspect principal bedroom and two further well-proportioned double bedrooms.

Location

The property is situated in an idyllic location near to the River Alyn, surrounded by beautiful countryside providing ample opportunities for walking, cycling and horse riding. A wide range of independent and national stores, a Tesco superstore and services including a community hospital can be found in Mold, which holds the distinction of being the first cittaslow (slow food town) in Wales and which has a strong culinary heritage, with a bi-weekly street market for fresh produce, a bi-monthly farmers' market and an annual Food & Drink Festival. Nearby Flint and the market town of Holywell also offer a wide range of amenities including independent and national stores and services, with the former benefitting from Asda and Sainsbury's supermarkets. More extensive sporting, leisure and retail facilities can be found in Wrexham and in Chester. Communications links are excellent: Flint train station has car parking and provides regular services to Chester, Crewe, Manchester and London, the latter in less than 2½ hours.

The area offers a wide range of state primary and secondary schooling together with a good selection of independent schools including Ruthin, Myddelton College and The King's and Queen's Schools.

Outside

Set back from the road behind low-level iron railings, the property is approached through a pedestrian gate over a gravelled path flanked by an area level lawn. The L-shaped walled courtyard garden to the rear is block paved for ease of maintenance, an ideal space for entertaining and al fresco dining and provides a gate to a rear pedestrian passageway and an outbuilding incorporating useful stores, the whole enjoying views over neighbouring rolling countryside.







Directions

Postcode for Sat Nav

CH7 6LZ

What3Words - Retain.Splitts.Rolled

General

Offers Over: £215,000

Local Authority: Flintshire Council

Services: Mains water & electricity, oil fired central heating.

This property has a private drainage system – full details to be provided on request

Council Tax: Band D

Fixtures and Fittings: All fixtures and fittings are excluded from the sale but may be available by separate negotiation.

Wayleaves and Easements: The property is sold subject to any wayleaves or easements whether mentioned in these particulars or not.

Chester

Park House, 37 Lower Bridge Street CH1 1RS

01244 354880

chester@struttandparker.com
struttandparker.com

@struttandparker

/struttandparker

50 offices across England and Scotland, including Prime Central London

Floorplans
House internal area 1,023 sq ft (95 sq m) For identification purposes only.

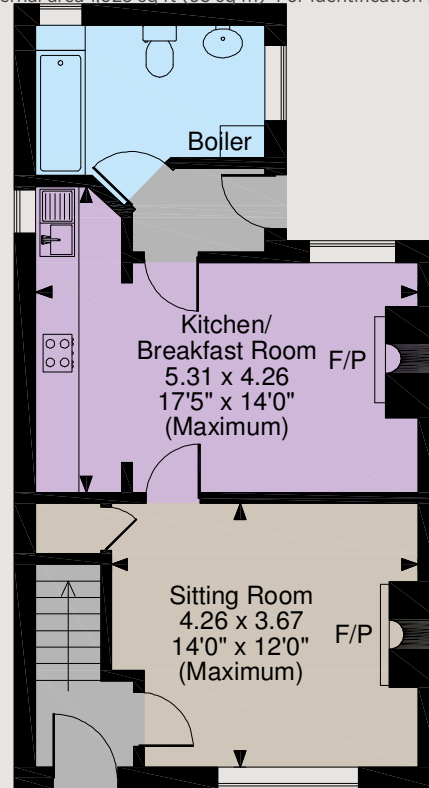

Ground Floor

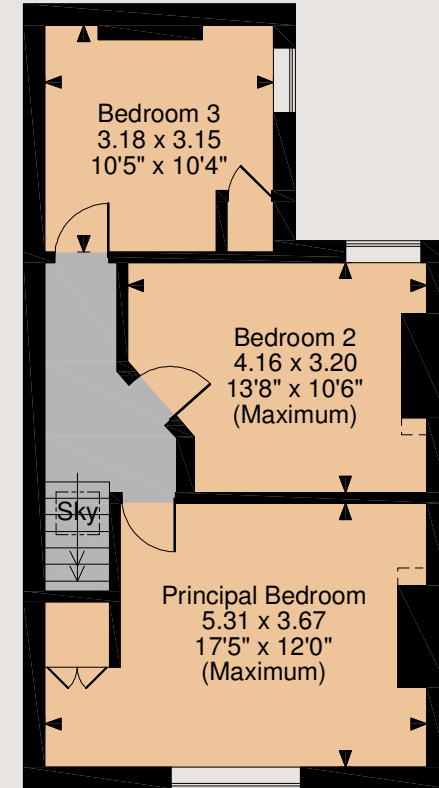

First Floor

The position & size of doors, windows, appliances and other features are approximate only.

Denotes restricted head height

© ehouse. Unauthorised reproduction prohibited. Drawing ref. dia/8517220/NGS

IMPORTANT NOTICE: Strutt & Parker gives notice that: 1. These particulars do not constitute an offer or contract or part thereof. 2. All descriptions, photographs and plans are for guidance only and should not be relied upon as statements or representations of fact. All measurements are approximate and not necessarily to scale. Any prospective purchaser must satisfy themselves of the correctness of the information within the particulars by inspection or otherwise. 3. Strutt & Parker does not have any authority to give any representations or warranties whatsoever in relation to this property (including but not limited to planning/building regulations), nor can it enter into any contract on behalf of the Vendor. 4. Strutt & Parker does not accept responsibility for any expenses incurred by prospective purchasers in inspecting properties which have been sold, let or withdrawn. 5. We are able to refer you to SPF Private Clients Limited ("SPF") for mortgage broking services, and to Alexander James Interiors ("AJI"), an interior design service. Should you decide to use the services of SPF, we will receive a referral fee from them of 25% of the aggregate of the fee paid to them by you for the arrangement of a mortgage and any fee received by them from the product provider. Should you decide to use the services of AJI, we will receive a referral fee of 10% of the net income received by AJI for the services they provide to you. 6. If there is anything of particular importance to you, please contact this office and Strutt & Parker will try to have the information checked for you. Photographs taken August 2022. Particulars prepared August 2022. Strutt & Parker is a trading style of BNP Paribas Real Estate Advisory & Property Management UK Limited