

# The Television Centre

London, W12



**STRUTT  
& PARKER**

BNP PARIBAS GROUP

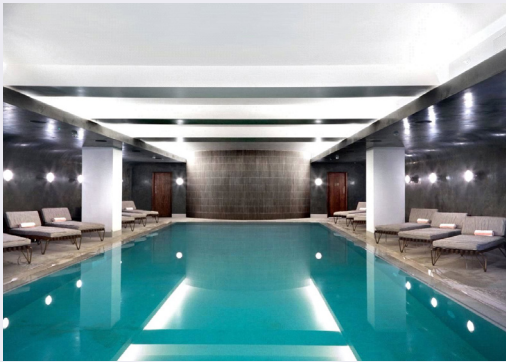
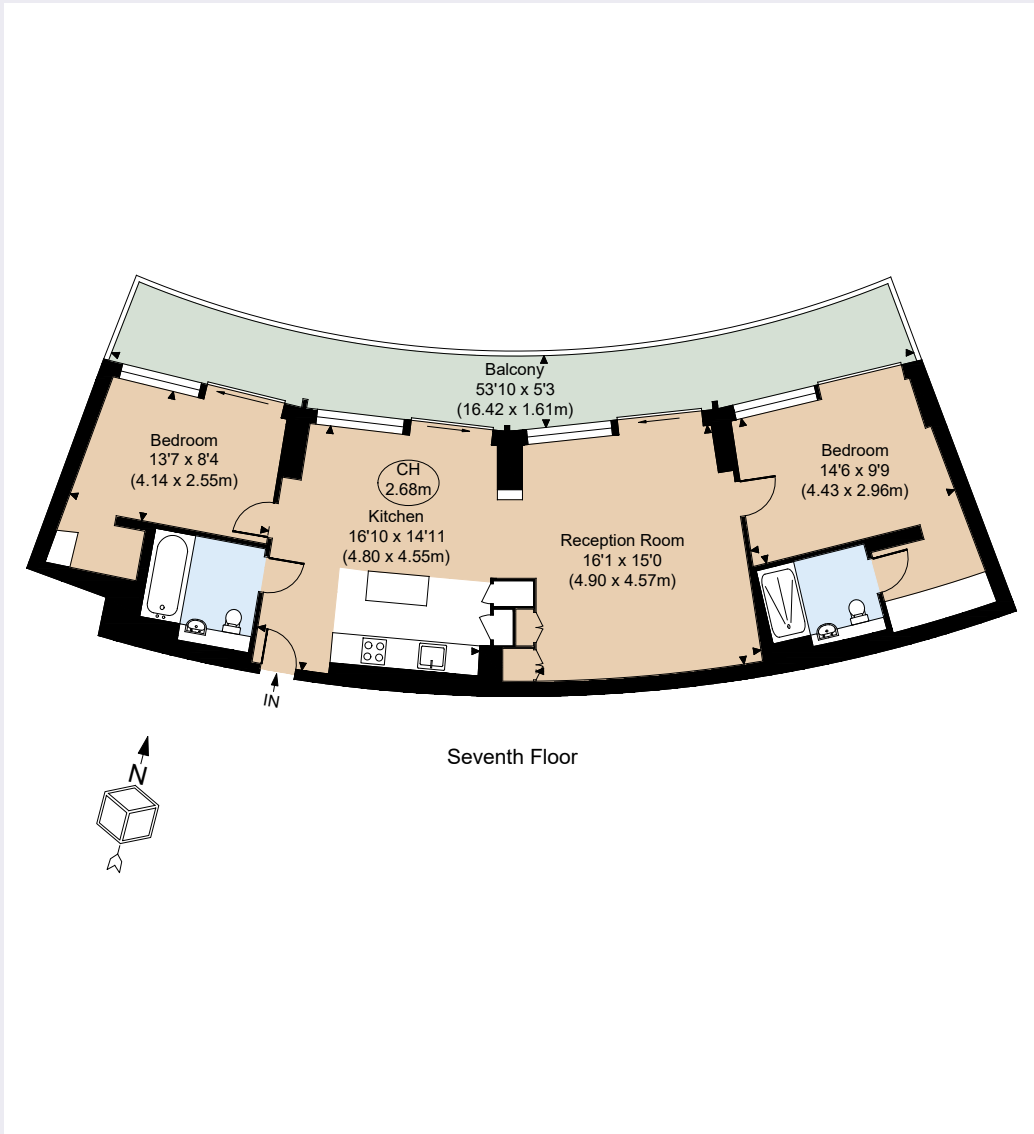

**An immaculate two-bedroom, two-bathroom seventh floor apartment with large balcony.**

Set within a renowned Grade II listed building, this apartment enjoys fantastic natural light.

The separate kitchen offers ample space for dining, plus there is an additional reception room. Both bedrooms feature bespoke fitted wardrobes and the principal bedroom benefits from a luxurious en suite shower room. The unusually large balcony stretched the entire length of the apartment. Parking is also included.

The building features lift access, residents' private gym, spa and pool by SOHO House, 24 hour concierge, residents lounge and screening and meeting rooms. The Television Centre is perfectly located close to White City, Wood Lane and Shepherds Bush underground stations and is further served by excellent over ground, bus and road routes into the West End and Canary Wharf.

**Floorplans**  
**Gross internal area 924 sq ft (85.80 sq m) including restricted height under 1.5m**  
**For identification purposes only.**

**General**  
**Tenure:** Leasehold of 975 years from and including 29 September 2017  
**Local Authority:** Hammersmith and Fulham  
**Service Charge:** Approx £14psf pa  
**Ground Rent:** £600pa  
**Council Tax:** Band F  
**EPC Rating:** B  
**Parking:** Right-to-Park  
**Broadband:** Available  
**Asking Price:** £1,200,000

**Notting Hill**  
 303 Westbourne Grove, London, W11 2QA

**020 7221 1111**  
 nottinghill@struttandparker.com  
 struttandparker.com

**IMPORTANT NOTICE:** Strutt & Parker gives notice that: 1. These particulars do not constitute an offer or contract or part thereof. 2. All descriptions, photographs and plans are for guidance only and should not be relied upon as statements or representations of fact. All measurements are approximate and not necessarily to scale. Any prospective purchaser must satisfy themselves of the correctness of the information within the particulars by inspection or otherwise. 3. Strutt & Parker does not have any authority to give any representations or warranties whatsoever in relation to this property (including but not limited to planning/building regulations), nor can it enter into any contract on behalf of the Vendor. 4. Strutt & Parker does not accept responsibility for any expenses incurred by prospective purchasers in inspecting properties which have been sold, let or withdrawn. 5. We are able to refer you to SPF Private Clients Limited ("SPF") for mortgage broking services, and to Alexander James Interiors ("AJI"), an interior design service. Should you decide to use the services of SPF, we will receive a referral fee from them of 25% of the aggregate of the fee paid to them by you for the arrangement of a mortgage and any fee received by them from the product provider. Should you decide to use the services of AJI, we will receive a referral fee of 10% of the net income received by AJI for the services they provide to you. 6. If there is anything of particular importance to you, please contact this office and Strutt & Parker will try to have the information checked for you. Photographs taken March 2025. Particulars prepared March 2025. Strutt & Parker is a trading style of BNP Paribas Real Estate Advisory & Property Management UK Limited



Over 50 offices across England and Scotland, including Prime Central London

For the finer things in property.

