

Whittingstall Road

Fulham, SW6



**STRUTT
& PARKER**

BNP PARIBAS GROUP

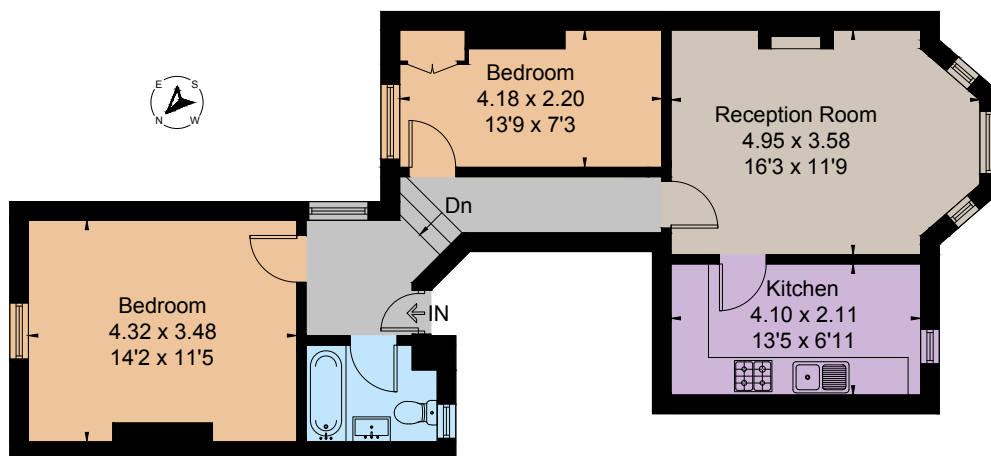

First Floor



A two bedroom flat on a prime Parsons Green road.

Located on the first floor of this imposing Victorian house. The property is 669 square foot consisting of a large and extremely bright reception room, separate kitchen, two double bedrooms and a bathroom.

Although presented in good condition the flat offers opportunities for incoming buyers to make improvements and potentially open up the kitchen reception room to one large open plan space.

Whittingstall Road is a prime residential street located off the Fulham Road. There is convenient access to Parsons Green Station 0.2 miles (District Line) and local bus routes. The Fulham Road, Parsons Green and Fulham Broadway offer a huge range of local shops, bars, and restaurants.

Floorplans

Gross internal area 669 sq ft (62.2 sq m)
For identification purposes only.

General

Tenure: Leasehold, 165 years 9 months
Local Authority: Hammersmith and Fulham
Service Charge: £1,300 per annum
Ground Rent: £250 per annum
Council Tax: Band E
EPC Rating: C
Parking: Residents' parking
Broadband: Available
OIEO: £650,000

Fulham

701 Fulham Road, London SW6 5UL

020 7731 7100

fulham@struttandparker.com
struttandparker.com

IMPORTANT NOTICE: Strutt & Parker gives notice that: 1. These particulars do not constitute an offer or contract or part thereof. 2. All descriptions, photographs and plans are for guidance only and should not be relied upon as statements or representations of fact. All measurements are approximate and not necessarily to scale. Any prospective purchaser must satisfy themselves of the correctness of the information within the particulars by inspection or otherwise. 3. Strutt & Parker does not have any authority to give any representations or warranties whatsoever in relation to this property (including but not limited to planning/building regulations), nor can it enter into any contract on behalf of the Vendor. 4. Strutt & Parker does not accept responsibility for any expenses incurred by prospective purchasers in inspecting properties which have been sold, let or withdrawn. 5. We are able to refer you to SPF Private Clients Limited ("SPF") for mortgage broking services, and to Alexander James Interiors ("AJI"), an interior design service. Should you decide to use the services of SPF, we will receive a referral fee from them of 25% of the aggregate of the fee paid to them by you for the arrangement of a mortgage and any fee received by them from the product provider. Should you decide to use the services of AJI, we will receive a referral fee of 10% of the net income received by AJI for the services they provide to you. 6. If there is anything of particular importance to you, please contact this office and Strutt & Parker will try to have the information checked for you. Photographs taken February 2025. Particulars prepared March 2025. Strutt & Parker is a trading style of BNP Paribas Real Estate Advisory & Property Management UK Limited



@struttandparker

Over 50 offices across England and Scotland,
including Prime Central London

For the finer things in property.

**STRUTT
& PARKER**

BNP PARIBAS GROUP